

THE TRAINING ROOM

Dimensions: 7m (L) x 3.5m (W) x 2.6m (H)
Area: 24.5m²
Theatre style: 40
Class room style: 20
Board room style: 24

THE BOARD ROOM

Dimensions: 4.7m (L) x 3.7m (W) x 2.6m (H)
Area: 17.4m²
Board room style: 12

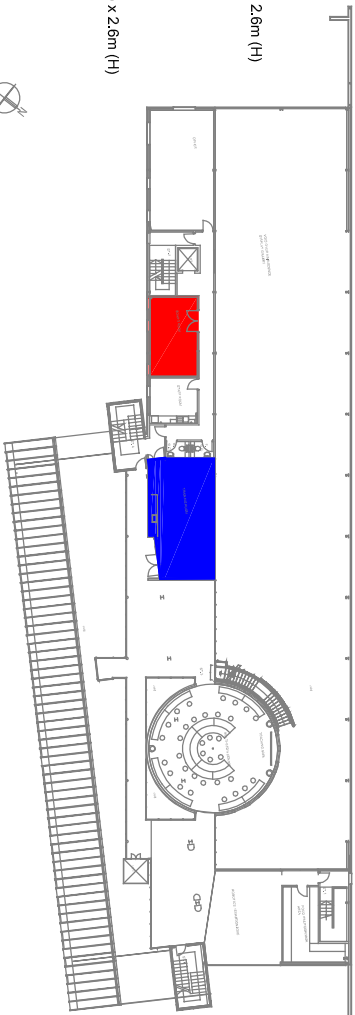

-FIRST FLOOR PLAN-

AUDITORIUM

Dimensions: 10m (L) x 5.2m (W) x 3.6m (H)
Area: 52.2m²
Theatre style: 70
Class room style: 40
Board room style: 30

THE PRISM

Dimensions: 30m (L) x 7.3m (W) x 8.3m (H)
Area: 219m²
Theatre style: 200
Banquet style: 150
Reception: 250

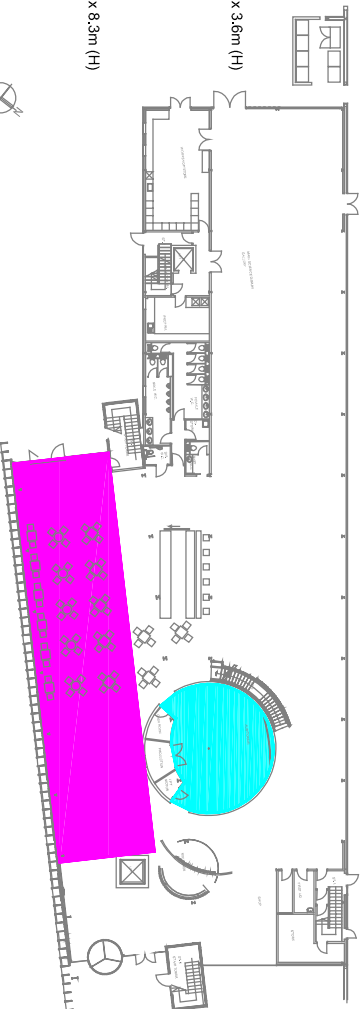

-GROUND FLOOR PLAN-